

SHELTER ASSEMBLY MANUAL

Model # 183017P
W5.5 x L9.15 x H5.3m

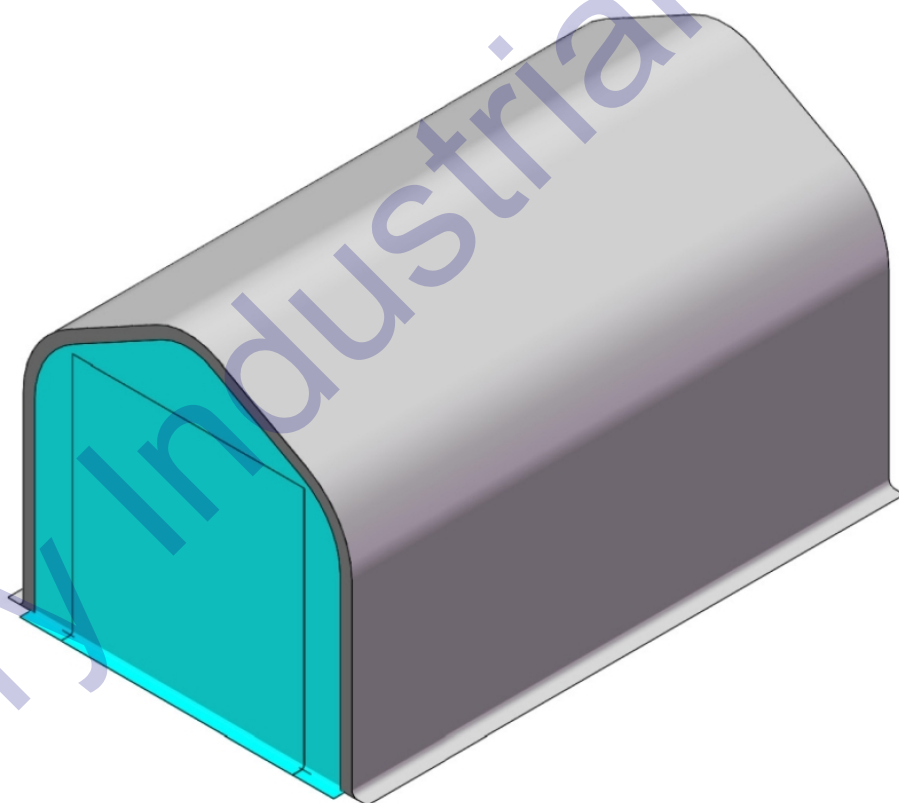

SPECIFICATION

Width: 5.5m Length: 9.15m Height: 5.3m

IMPORTANT-----READ MANUAL FIRST

Improper site preparation, Assembly and Maintenance may invalidate warranty and cause unnecessary and costly mistake. If you have any questions contact your local dealer.

For User Friendly assembly we have identified each individual component with the part code as indicated in the parts list. Please refer to the part code numbers and drawing to ensure problem free assembly.

It's necessary to tighten the roof fabric enough to avoid "hammocks" on the roof and also re-tighten once or twice again after a few months of use. This is important when assembly in cold weather (autumn and winter) because the fabric is stiff then and when we got the sun and warm weather afterwards it will make the fabric "slack" again and need to be re-tighten before next winter.

It's the owners responsibility to take of snow immediately if not slide off by itself.

READ ALL INSTRUCTIONS BEFORE ASSEMBLY

1. Keep work area clean. Cluttered areas invite injuries. Do not set up near snow drifts, in slippery places, in high winds, or wet location.
2. Keep children away. All children should be kept away from the work area.
3. Don't over reach. Keep proper footing and balance at all times.
4. Do not assemble in under the influence of alcohol or drugs. Read warning labels on prescriptions to determine if your judgment or reflexes are impaired while taking drugs. If there is any doubt, do not assemble.
5. Be aware of possible windy conditions; fasten the bases in concrete if these conditions are likely to occur. Remove the cover during hurricane.
6. Be careful with power and heat sources. Do not keep heat sources near the tarpaulin. Do not expose to open flame.
7. Be aware of personal safety during assembly and use. Be careful not to pinch fingers with clips and tubes when assembling: when using makes sure there is adequate ventilation for exhaust and other dangerous fumes.

183017P(Width: 5.5m Length: 9.15m Height: 5.3m, 1.525m Arch Spacing)

NO.	Description--5ft Arch spacing	QTY
1	Roof bent tube	7
2	Shoulder bent tube	10
2A	Shoulder bent tube for front and back doors	4
3	Upright tube	10
3A	Upright tube for front and back door	4
4	Purlin	30
5L	Base plate at left	2
5R	Base plate at right	2
6	Base plate at middle	10
7	Base plate for front and back doors	4
8	Lower standing leg for front and back doors	4
9	Upper standing leg for front and back doors	4
10	Upper beam for front and back door	4
11	Lower tensioning tube for front and back door	4

12	Tension accessories	8
12A	Clip	8
13	Tension Tube	8 2 groups
14	Vertical tube for front and back door	4 2 groups
15	Stake peg	50
16	Carriage Bolt M12x110mm	39
17	Carriage Bolt M10x90mm	104
18	Bolt M10x30mm	8
19	Bolt M10x60mm	2
20	Ratchet	14
21	Roof Cover	1
22	Front and Back cover	2
23	Rope	1
24	Tension Belt	14
25	Plastic cap	10
26	Nylon pulley	4 2 groups

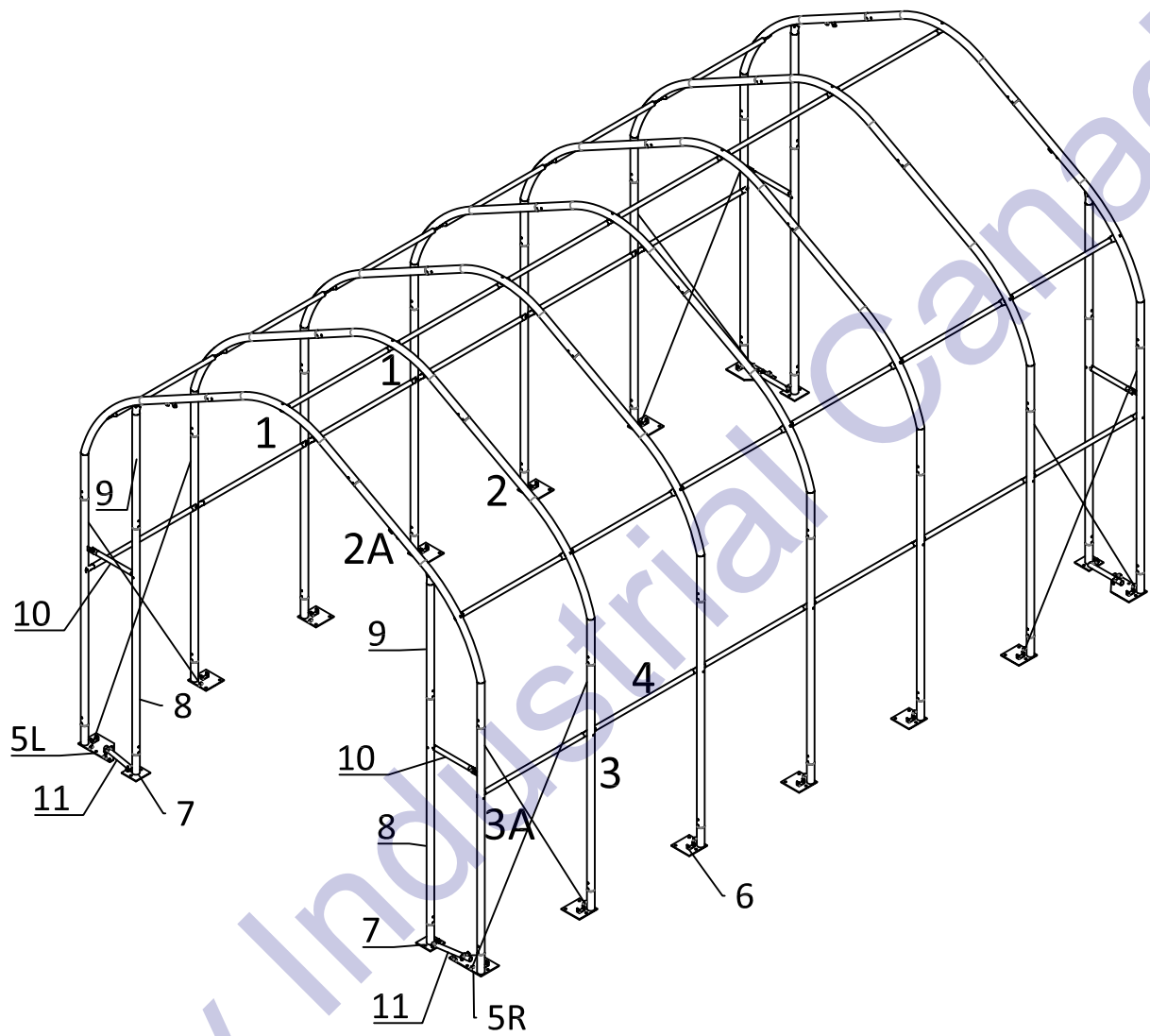

EQUIPMENT AND TOOLS FOR INSTALLATION

1. Measuring tape
2. String for alignment
3. Stakes
4. Ladder or Scissors lift
5. Sledge hammer
6. Drill
7. Wrench
8. Knife

A—BASE INSTALLATION

Please refer to the diagram (Figure 2) to place the base plates. (Unit: mm)

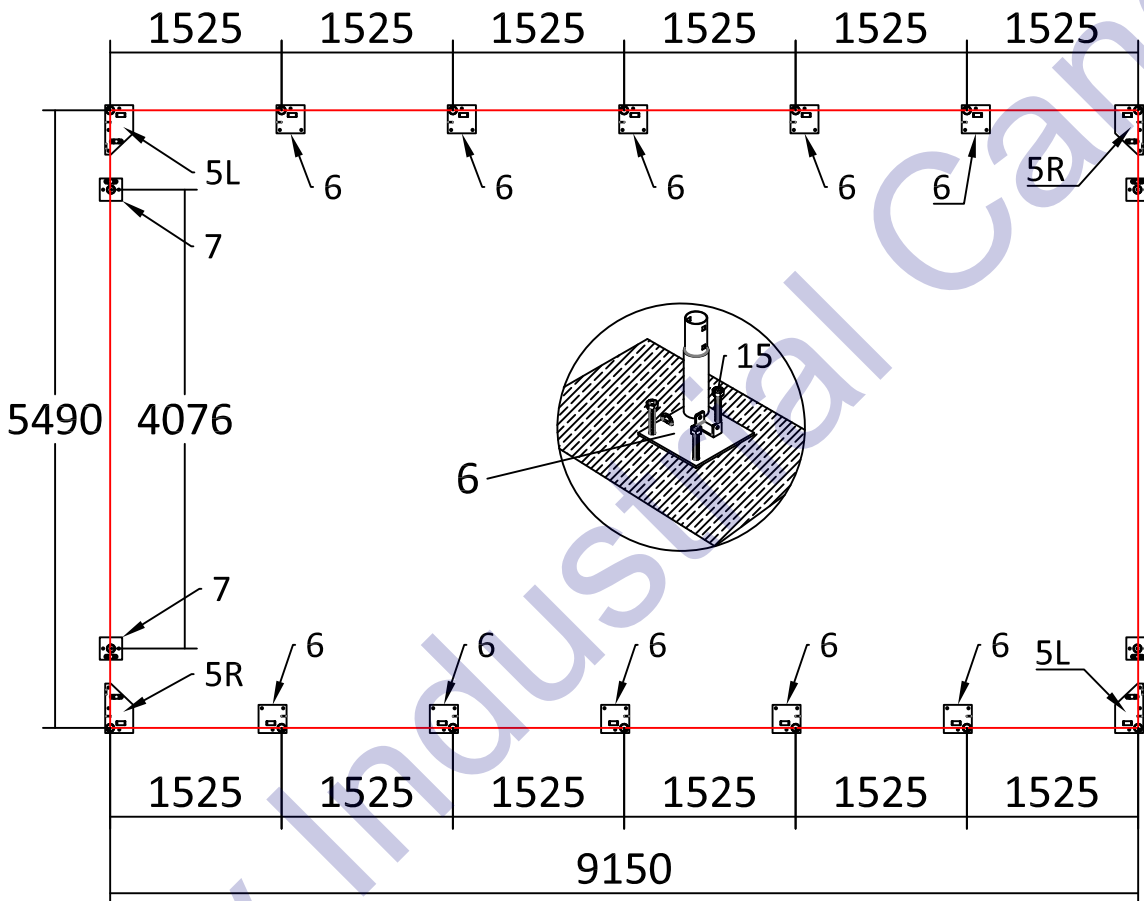

Figure 2

1. The measurement is from center to center of tubes on the base plates. Referring to the above diagram and confirm the place of base plates. There are holes on the plates for stake pegs.

2. Please refer to the diagram (Figure 2) to place the base plates:

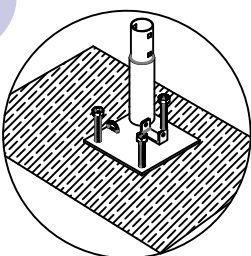

Figure 3

Mark the stake peg hold through the base plate by using the stake peg. Move the base plates away and the mark determines where the stake peg will be.

Note: The stake peg apply for normal conditions, not suitable to the rock ground, frozen soil and concrete ground

B---FRAME INSTALLATION

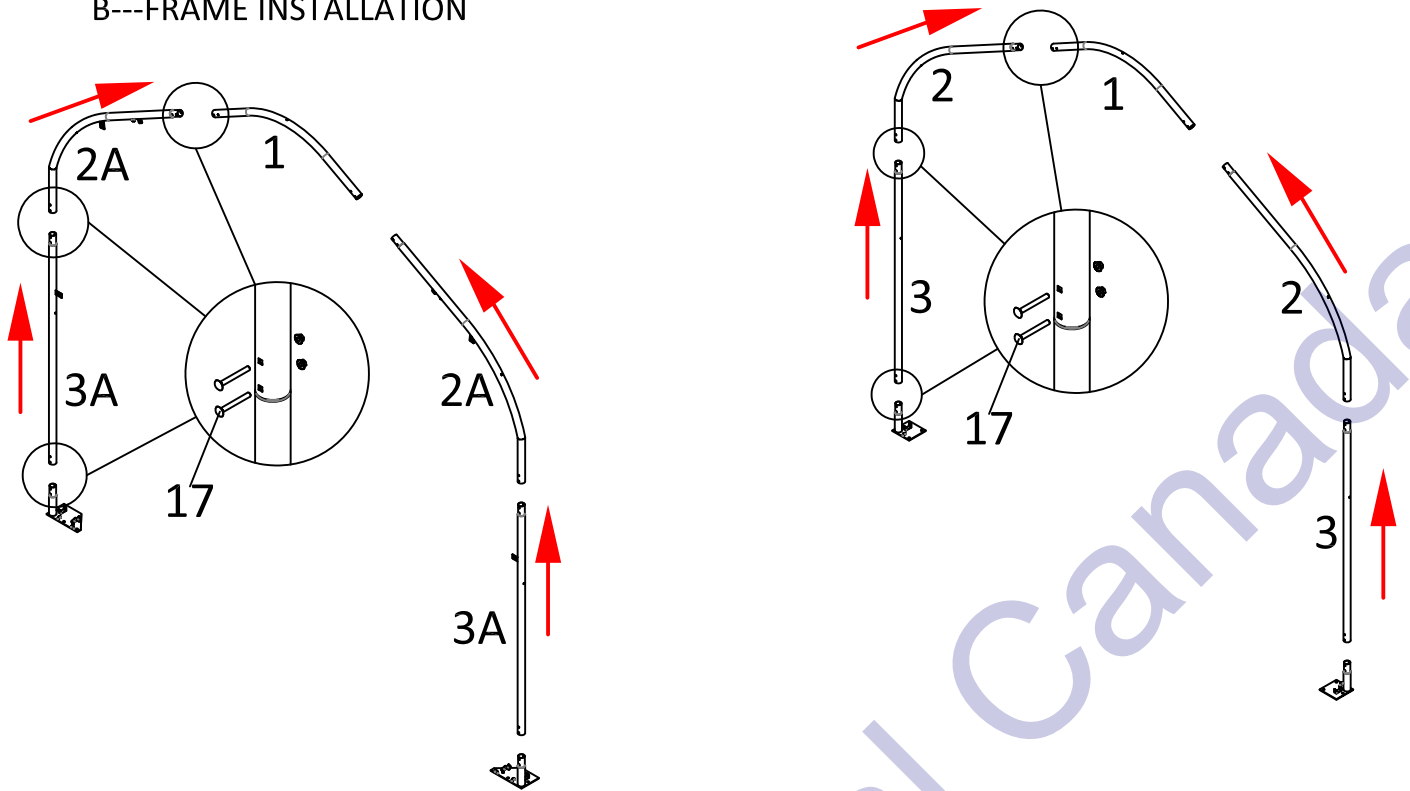

Figure 4

As Figure 4 shown to find one Top bent Tube (No.1), two of Middle bent tube (No. 2), two of Standing leg(No. 3) to be one group for front and back door,and assemble every group arch with Screw M10x90mm (No.17).

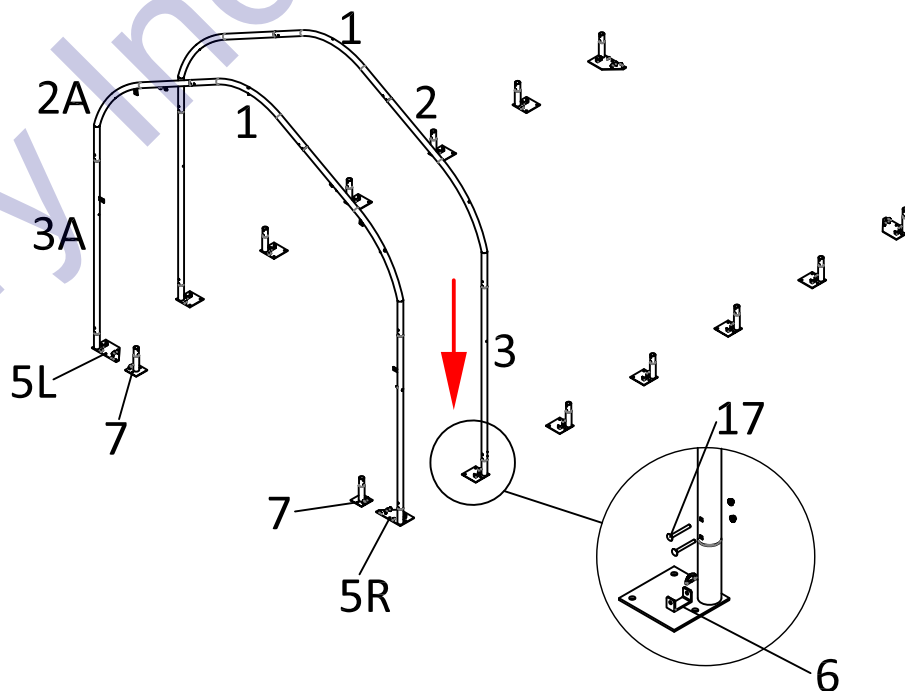

Figure 5

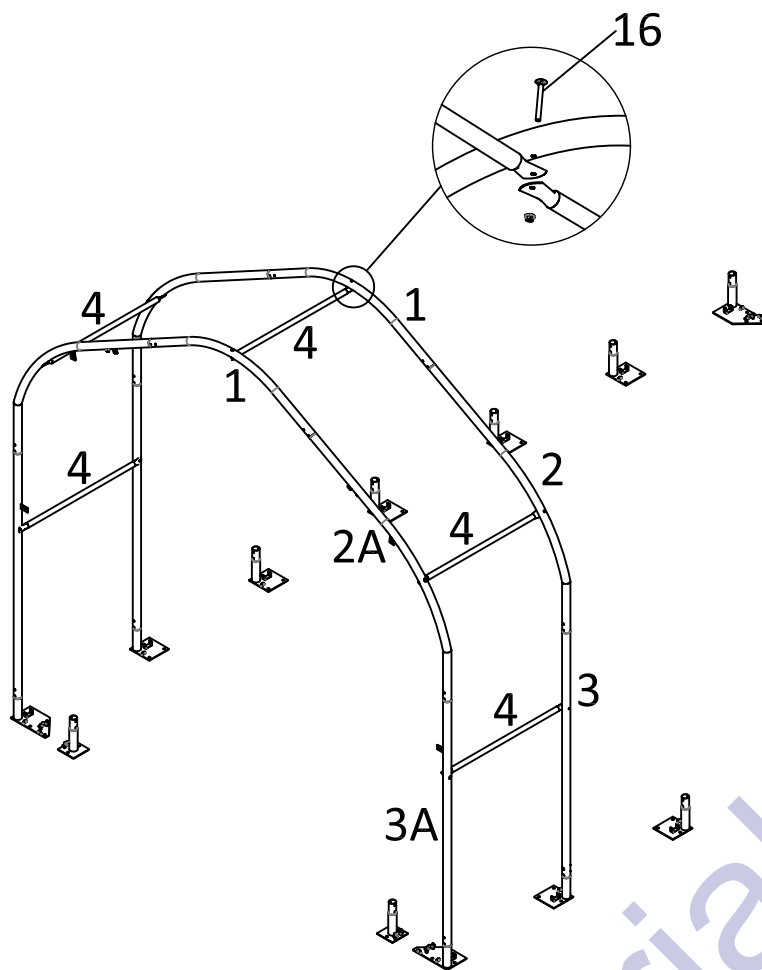

Figure 6

Figure 5 shown when finish installing the first two arches into the base plates, use Purlin (No.4) to connect them by Screw M12x110mm(No.16).

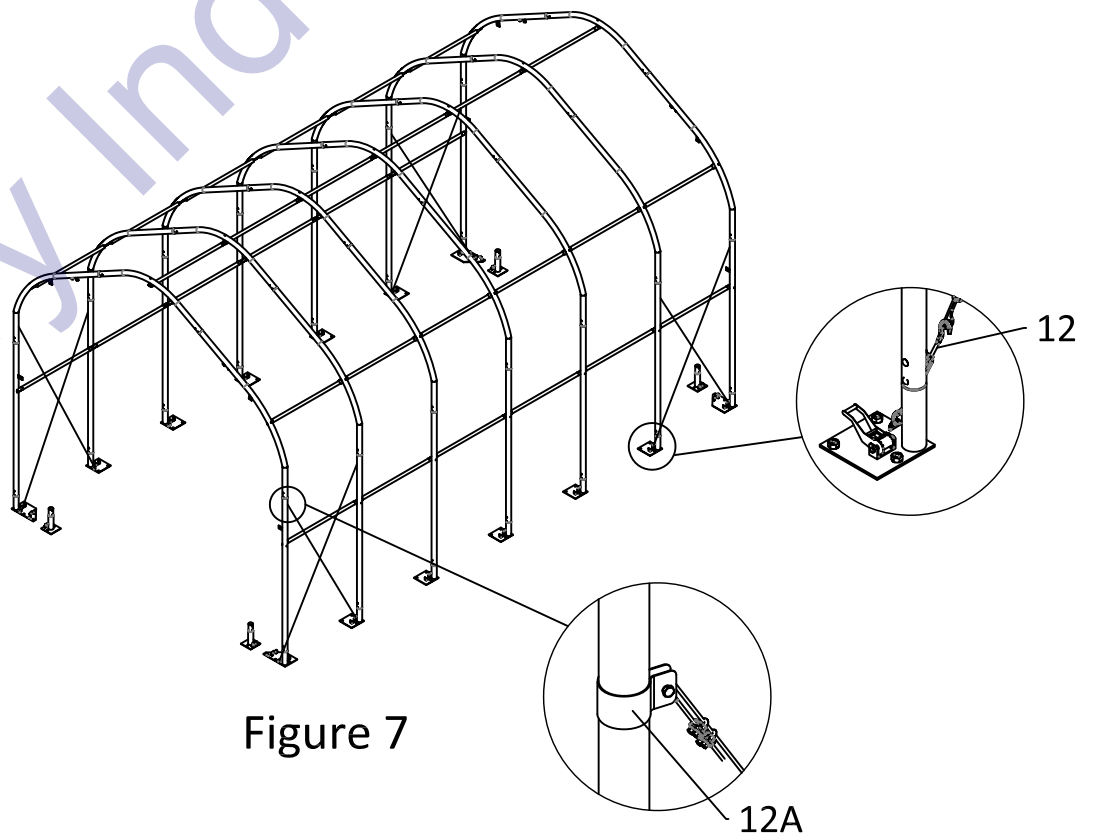

Figure 7

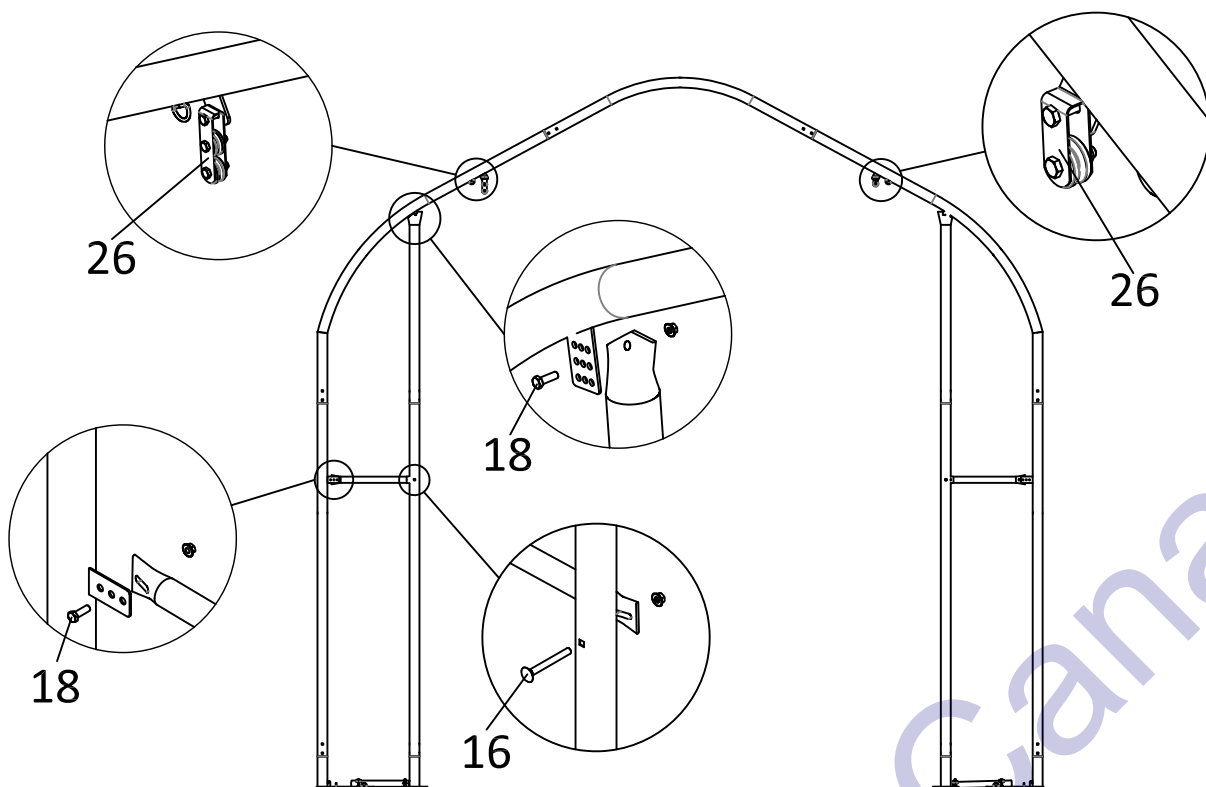

Figure 8

Install the front and back door frame as Figure 8.

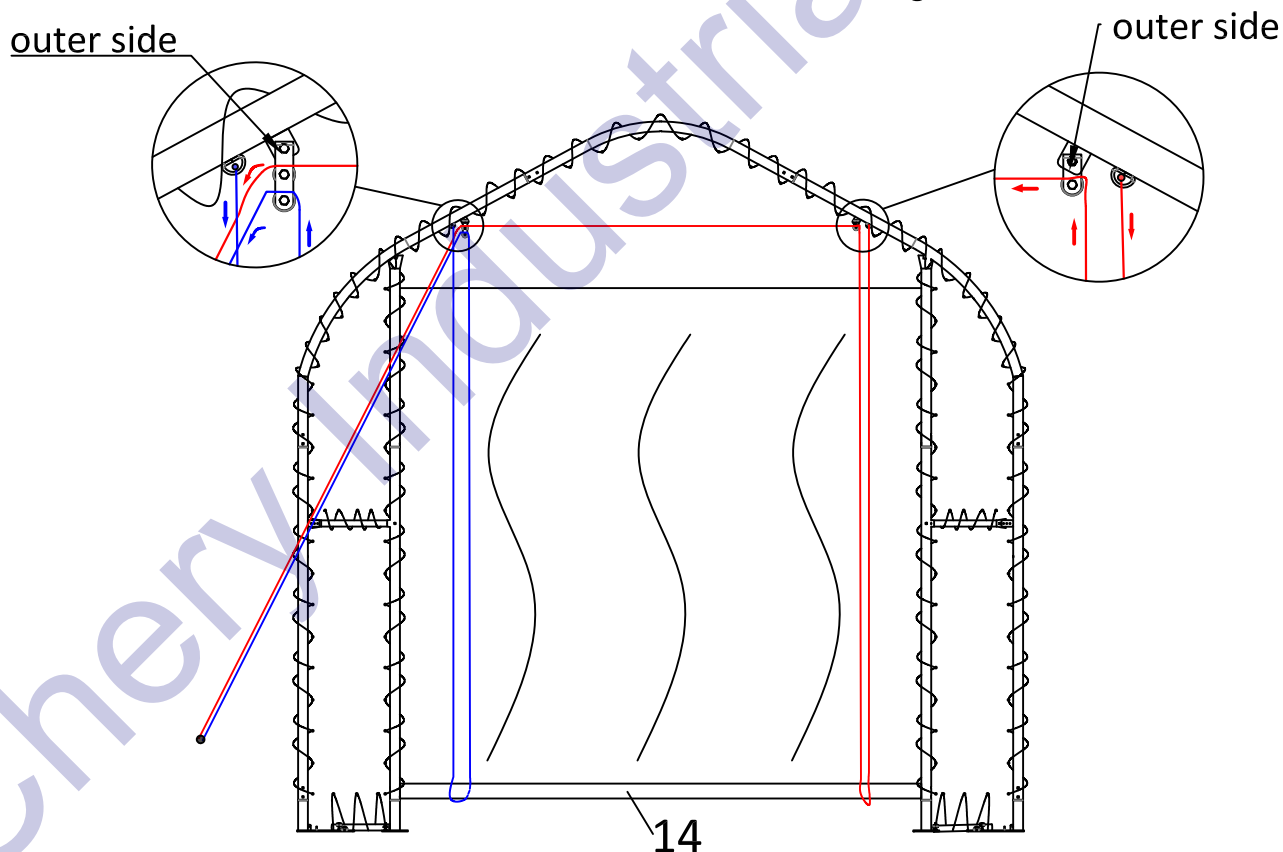

Figure 8

Use Knitting Rope (No.23) on Front and Back cover to lace the grommets in the end to the tensioning tubes evenly. The end covers are tied to the frame (Roof, Middle & Lower Bent Tube) by Knitting Rope.

They are also been secured to the end frame (door tube and side rail) by Knitting Rope.

Make the cover well tidy the Back Cover and Front Cover. Fasten the band inside the end of the roof cover, make the cover well fold to the frame and tie the end of the band to the Clips on Base Plates at four corners.

D---ROOF COVER INSTALLATION

NOTE:DO NOT install the cover onto the frame of your building in high wind conditions. A slight breeze is the most advantageous for cover installation. To take advantage of the breeze, pull the cover up over the arches with the breeze blowing in the cover like a sail filled with air.

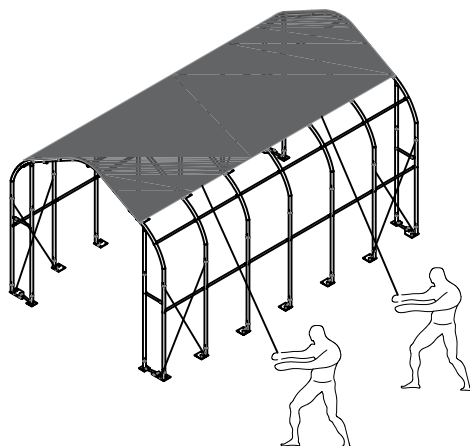

Figure 10

Pull the Roof Cover (No.21) over the frame EVENLY, CAREFULLY AND SLOWLY.

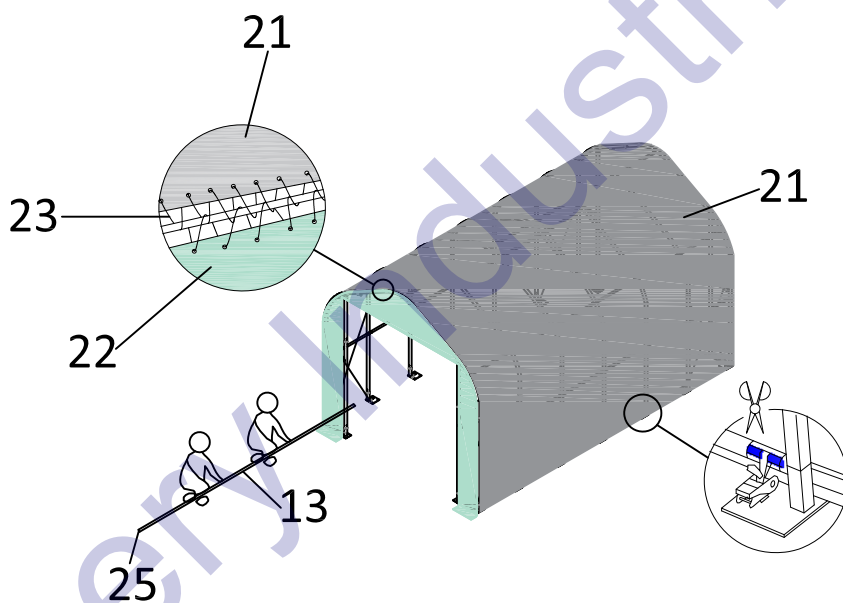

Figure 11

Insert the tensioning tubes (No.13) . Loosely secure the Nylon Band (No.24) in the Winch. DO NOT TIGHTEN. Adjust the cover so that it is square and evenly centered on the frame. Put the lower tensioning tube inside and install the Plastic cap (No.25) into each end of lower tensioning tubes.

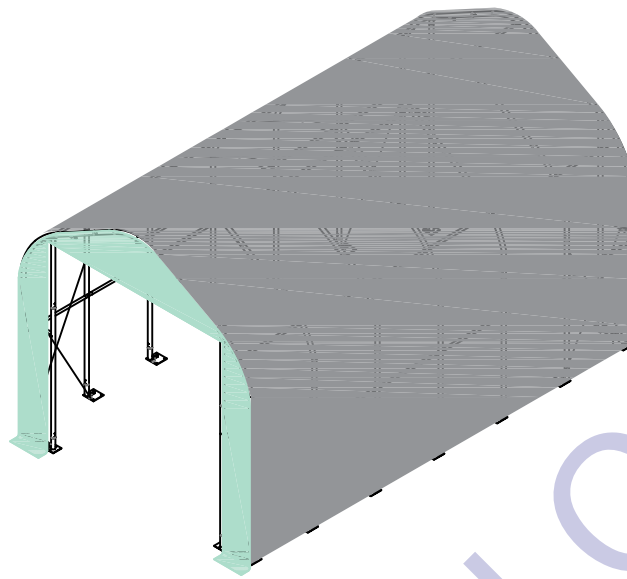

Figure 12

CONGRATULATIONS: NOW YOUR ASSEMBLY IS COMPLETED.

NOTE:

1. Cloth tape for wrapping the gaps on the frame after frame installation.
2. Please adjust the roof cover every month. It's necessary to make the cover flat and well tensioned.

SAVE THIS MANUAL
FOR FUTURE REFERENCE!